

SGM-B

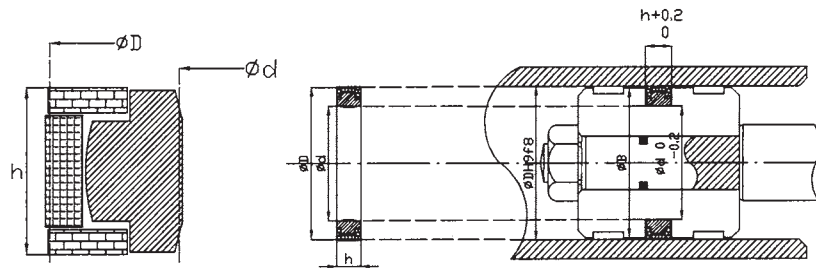

NO	SIZE OF SET	ITEM	Ø D		Ø d		h	
	SGM B							
1	50 (50 X 36 X 8,5)	PTFE. + Bronze + Carbon Rubber Black Nylon	50		36		8.5	
2	55 (55 X 41 X 8,5)	PTFE. + Bronze + Carbon Rubber Black Nylon	55		41		8,5	
3	60 (60 x 46 x 8.5)	PTFE. + Bronze + Carbon Rubber Black Nylon	60		46		8,5	
4	65 (65 x 50 x 10.5)	PTFE. + Bronze + Carbon Rubber Black Nylon	65		50		10,5	
5	70 (70 x 55 x 10.5)	PTFE. + Bronze + Carbon Rubber Black Nylon	70		55		10,5	
6	75 (75 x 60 x 10.5)	PTFE. + Bronze + Carbon Rubber Black Nylon	75		60		10,5	
7	80 (80 x 65 x 10,5)	PTFE. + Bronze + Carbon Rubber Black Nylon	80		65		10,5	
8	85 (85 x 70 x 10,5)	PTFE. + Bronze + Carbon Rubber Black Nylon	85		70		10,5	
9	90 (90 x 75 x 10,5)	PTFE. + Bronze + Carbon Rubber Black Nylon	90		75		10,5	
10	95 (95 x 80 x 10,5)	PTFE. + Bronze + Carbon Rubber Black Nylon	95		80		10,5	

NO	SIZE OF SET	ITEM	Ø D		Ø d		h	
	SGM B							
11	100 (100 x 85 x 12)	PTFE. + Bronze + Carbon Rubber Black Nylon	100		85		12	
12	105 (105 x 90 x 12)	PTFE. + Bronze + Carbon Rubber Black Nylon	105		90		12	
13	110 (110 x 95 x 12)	PTFE. + Bronze + Carbon Rubber Black Nylon	110		95		12	
14	115 (115 x 100 x 12)	PTFE. + Bronze + Carbon Rubber Black Nylon	115		100		12	
15	120 (120 x 105 x 12)	PTFE. + Bronze + Carbon Rubber Black Nylon	120		105		12	
16	125 (125 x 110 x 15,5)	PTFE. + Bronze + Carbon Rubber Black Nylon	125		110		15,5	
17	130 (130 x 107 x 15,5)	PTFE. + Bronze + Carbon Rubber Black Nylon	130		107		15,5	
18	135 (135 x 112 x 15.5)	PTFE. + Bronze + Carbon Rubber Black Nylon	135		112		15,5	
19	140 (140 x 117 x 15.5)	PTFE. + Bronze + Carbon Rubber Black Nylon	140		117		15,5	
20	145 (145 x 122 x 15.5)	PTFE. + Bronze + Carbon Rubber Black Nylon	145		122		15,5	
21	150 (150 x 127 x 15.5)	PTFE. + Bronze + Carbon Rubber Black Nylon	150		127		15,5	
22	155 (155 x 132 x 15.5)	PTFE. + Bronze + Carbon Rubber Black Nylon	155		132		15,5	
23	160 (160 x 137 x 15.5)	PTFE. + Bronze + Carbon Rubber Black Nylon	160		137		15,5	
24	165 (165 x 142 x 15,5)	PTFE. + Bronze + Carbon Rubber Black Nylon	165		142		15,5	
25	170 (170 x 147 x 15,5)	PTFE. + Bronze + Carbon Rubber Black Nylon	170		147		15,5	
26	175 (175 x 152 x 15.5)	PTFE. + Bronze + Carbon Rubber Black Nylon	175		152		15,5	
27	180 (180 x 157 x 15.5)	PTFE. + Bronze + Carbon Rubber Black Nylon	180		157		15,5	
28	185 (185 x 162 x 15.5)	PTFE. + Bronze + Carbon Rubber Black Nilon	185		162		15,5	

NO	SIZE OF SET	ITEM	Ø D		Ø d		h	
	SGM B							
29	190 (190 x 167 x 15.5)	PTFE. + Bronze + Carbon Rubber Black Nilon	190		167		15,5	
30	200 (200 x 177 x 15.5)	PTFE. + Bronze + Carbon Rubber Black Nilon	200		177		15,5	
31	205 (205 x 182 x 15,5)	PTFE. + Bronze + Carbon Rubber Black Nilon	205		182		15,5	
32	210 (210 x 187 x 15,5)	PTFE. + Bronze + Carbon Rubber Black Nilon	210		187		15,5	
33	215 (215 x 192 x 15.5)	PTFE. + Bronze + Carbon Rubber Black Nilon	215		192		15,5	
34	220 (220 x 197 x 15.5)	PTFE. + Bronze + Carbon Rubber Black Nilon	220		197		15,5	
35	225 (225 x 202 x 15.5)	PTFE. + Bronze + Carbon Rubber Black Nilon	225		202		15,5	
36	230 (230 x 207 x 15.5)	PTFE. + Bronze + Carbon Rubber Black Nilon	230		207		15,5	
37	235 (235 x 212 x 15.5)	PTFE. + Bronze + Carbon Rubber Black Nilon	235		212		15,5	
38	240 (240 x 217 x 15,5)	PTFE. + Bronze + Carbon Rubber Black Nilon	240		217		15,5	
39	250 (250 x 222 x 17)	PTFE. + Bronze + Carbon Rubber Black Nilon	250		222		17	
40	260 (260 x 232 x 17)	PTFE. + Bronze + Carbon Rubber Black Nilon	260		232		17	
41	270 (270 x 242 x 17)	PTFE. + Bronze + Carbon Rubber Black Nilon	270		242		17	
42	280 (280 x 252 x 17)	PTFE. + Bronze + Carbon Rubber Black Nilon	280		252		17	
43	290 (290 x 262 x 17)	PTFE. + Bronze + Carbon Rubber Black Nilon	290		262		17	
44	300 (300 x 272 x 17)	PTFE. + Bronze + Carbon Rubber Black Nilon	300		272		17	
45	330 (330 x 302 x 17)	PTFE. + Bronze + Carbon Rubber Black Nilon	330		302		17	